

Category	Test Item	Specimen Type	Specimen Volume	Reaction Time	Measuring Range	Clinical Reference	Qualification
COVID-19	SARS-CoV-2 Antibody	WB/Serum/Plasma	10 µL	10 min	Qualitative	Negative	CE
	SARS-CoV-2 IgM	WB/Serum/Plasma	10 µL	10 min	Qualitative	Negative	CE
	SARS-CoV-2 IgM/IgG	WB/Serum/Plasma	10 µL	10 min	Qualitative	Negative	CE
Vitamin	Vitamin D	Serum/Plasma	75 µL	15 min	5-100 ng/mL	30-100 ng/mL	CE
Diabetic & Renal Injury Markers	HbA1c	WB	10 µL	5 min	4.0-14.5%	4-6.5%	CE IFCC NGSP
	MAU	Urine	75 µL	3 min	5-300 mg/L	0-20 mg/L	CE
	CysC	WB/Serum/Plasma	10 µL	5 min	0.2-10 mg/L	0.5-1.1 mg/L	CE
	NGAL	Urine	75 µL	15 min	10-1500 ng/mL	≤131.7 ng/mL	CE
	β2-MG	WB/Serum/Plasma	10 µL	10 min	0.3-20 mg/L	1.0-2.7 mg/L	CE
Thyroid Function	T3	WB/Serum/Plasma	75 µL	15 min	0.61-9.22 nmol/L	1.23-3.07 nmol/L	CE
	T4	WB/Serum/Plasma	75 µL	15 min	12.87-300 nmol/L	66-181 nmol/L	CE
	TSH	WB/Serum/Plasma	75 µL	15 min	0.1-100 mIU/L	0.3-4.2 mIU/L	CE
	FT3	WB/Serum/Plasma	75 µL	15 min	0.40-50.00 pmol/L or 0.26-32.55 pg/mL	2.8-7.1 pmol/L (1.82-4.61 pg/mL)	CE
	FT4	WB/Serum/Plasma	75 µL	15 min	1.00-100 pmol/L or 0.078-7.77 ng/dL	12-22 pmol/L (0.94-1.72 ng/dL)	CE
Fertility	β-HCG	WB/Serum/Plasma	20 µL	15 min	2-200,000 mIU/mL	5 mIU/mL	CE
	LH	WB/Serum/Plasma	75 µL	15 min	1-100 mIU/mL	Male: 1.70-8.60 mIU/mL. Female: Follicular phase: 2.95-13.65 mIU/mL Ovulation phase: 13.65-95.75 mIU/mL Luteal phase: 1.25-11.00 mIU/mL Menopause phase: 8.24-55.23 mIU/mL	CE
	FSH	WB/Serum/Plasma	75 µL	15 min	1-100 mIU/mL	Male: 1.50-12.40 mIU/mL. Female: Follicular phase: 4.46-12.43 mIU/mL Ovulation phase: 4.88-20.96 mIU/mL Luteal phase: 1.96-7.70 mIU/mL Menopause phase: 22.70-130.00 mIU/mL	CE
	Prog	WB/Serum/Plasma	75 µL	15 min	1.5-60 ng/mL	Male: 0.2-1.5 ng/mL. Female: Follicular phase: 0.2-2.0 ng/mL Ovulation phase: 0.7-3.5 ng/mL Luteal phase: 3.0-30 ng/mL Menopause phase: 0.1-3.9 ng/mL 7 weeks of pregnancy: 24.5-7.6 ng/mL 9-12 weeks of pregnancy: 38.0-13.0 ng/mL	CE
	PRL	WB/Serum/Plasma	75 µL	15 min	1-200 ng/mL	Female (non-pregnant): 4.60-25.07 ng/mL Male: 3.45-17.42 ng/mL	CE
	E2	WB/Serum/Plasma	75 µL	15 min	9-3000 pg/mL	Male: <85 pg/mL Female: Follicular Phase: 12-262 pg/mL Ovulation: 40-399 pg/mL Luteal Phase: 21-351 pg/mL Menopause: <190 pg/mL Pregnancy: >145 pg/mL	CE
	Testosterone	WB/Serum/Plasma	75 µL	15 min	0.2-15 ng/mL	Male: 20-49 years old: 1.61-8.41 ng/mL ≥50 years old: <0.61 ng/mL Female: 20-49 years old: 0.50 ng/mL ≥50 years old: <0.71 ng/mL	CE
	AMH	WB/Serum/Plasma	75 µL	15 min	0.1-16 ng/mL	Male: 20-60 years old: 0.92-13.89 ng/mL Female: 20-29 years old: 0.88-10.35 ng/mL 30-39 years old: 0.31-7.86 ng/mL 40-50 years old: ≤5.07 ng/mL	CE
Cardiac Markers	NT-proBNP	WB/Serum/Plasma	75 µL	15 min	18-35000 pg/mL	<75 years old: 0-300 pg/mL ≥75 years old: 0-450 pg/mL	CE
	cTn I	WB/Serum/Plasma	75 µL	15 min	0.1-50 ng/mL	0-0.3 ng/mL	CE
	Myo	WB/Serum/Plasma	75 µL	15 min	2.0-400 ng/mL	0-58 ng/mL	CE
	CK-MB	WB/Serum/Plasma	75 µL	15 min	0.3-100 ng/mL	0-5 ng/mL	CE
	H-FABP	WB/Serum/Plasma	75 µL	15 min	1-120 ng/mL	0-7 ng/mL	CE
	3 in 1 (cTn I/Myo/CK-MB)	WB/Serum/Plasma	75 µL	15 min	Same with single items	Same with single items	CE
	BNP	WB/Plasma	75 µL	15 min	5-5000 pg/mL	0-100 pg/mL	CE
	2 in 1 (cTn I/ NT-proBNP)	WB/Serum/Plasma	75 µL	15 min	Same with single items	Same with single items	CE
	hsCRP	WB/Serum/Plasma	10 µL	3 min	0.1-10 mg/L	≤1.0 mg/L	CE
	TnT	WB/Serum/Plasma	100 µL for whole blood 75 µL for plasma/serum	15 min	0.03-10 ng/mL	0-0.1 ng/mL	CE
Lp-PLA2	WB/Serum/Plasma	75 µL	15 min	10-1000 ng/mL	<225 ng/mL	CE	
Coagulation	D-Dimer	WB/Plasma	15 µL for whole blood 10 µL for plasma	5 min	0.1-10 mg/L	0-0.5 mg/L	CE
	D-Dimer one step	WB/Plasma	100 µL for whole blood 75 µL for plasma	15 min	0.1-10 mg/L	0-0.5 mg/L	CE
Inflammation Markers	PCT	WB/Serum/Plasma	75 µL for whole blood 50 µL for plasma/serum	15 min	0.1-100 ng/mL	0-0.5 ng/mL	CE
	CRP (hsCRP+CRP)	WB/Serum/Plasma	8.5 µL for whole blood 5 µL for plasma/serum	3 min	0.5-200 mg/L	CRP:0-10 mg/L hsCRP:0-1 mg/L	CE
	2 in 1 (CRP+PCT)	WB/Serum/Plasma	75 µL	15 min	CRP:0.5-150 mg/L PCT:0.1-100 ng/mL	CRP:<10 mg/L PCT:<0.5 ng/mL	CE
	SAA	WB/Serum/Plasma	10 µL	15 min	1.0-300 mg/L	0-10 mg/L	CE
	IL-6	WB/Serum/Plasma	75 µL	15 min	3~4000 pg/mL	≤10 pg/mL	CE
Tumor Markers	AFP	WB/Serum/Plasma	75 µL	15 min	5-400 ng/mL	0-20 ng/mL	CE
	PSA	WB/Serum/Plasma	75 µL	15 min	2-100 ng/mL	0-4 ng/mL	CE 9123
	CEA	WB/Serum/Plasma	75 µL	15 min	1-500 ng/mL	0-5 ng/mL	CE
	fPSA	WB/Serum/Plasma	75 µL	15 min	0.2-30 ng/mL	< 1 ng/mL	CE 9123
Craniocerebral Injury Markers	S100β	WB/Serum/Plasma	75 µL	15 min	0.05-10 ng/mL	<0.2 ng/mL	CE
Others	Cortisol	WB/Serum/Plasma	75 µL	15 min	50-1000 nmol/L	7:00-10:00 a.m.: 201.31-536.54 nmol/L 4:00-8:00 p.m.: 65.78-330.85 nmol/L	CE



Finecare™ FIA Meter III Plus (FS-205)

Fluorescence Immunoassay Analyzer

Finecare™ FIA METER III PLUS

Multi-Channel

20 channels, detect more items one time

Reliable Accuracy

Good correlation with CLIA method

Temperature control

Provide better reaction condition

Rapid Test

High speed of detection, enable 200 tests per hour

FS-205

- Dimensions: 374*396*480.5 mm
- Weight: Approx. 19.5Kg

ID chip inlet

- Automatically reading of batch number and calibration information in the ID chip

Test Channel

- 20 channels
- Random access for samples
- Automatic internal incubation

Built-in Thermal Printer

- Real-time auto-printing
- Support for external printers

Designed Sampler

- Specially-designed sampler for small volume of specimen

Large Display

- 10" LCD Touch Screen
- Intuitive user interface

Connection

- Direct connection to LIS/HIS

Cartridge Tray

- Cartridges will be automatically ejected into the tray when test is finished

Test Reagent

- Room temperature storage
- Suitable for whole blood, serum, plasma and urine
- Get results in 3-15 minutes

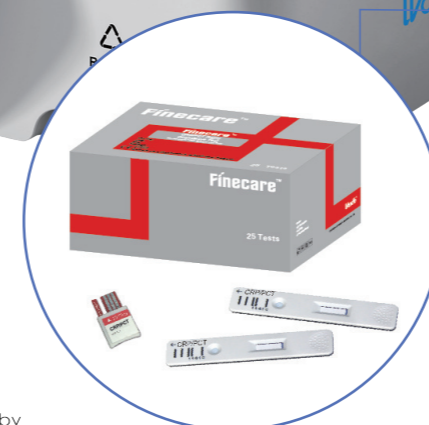
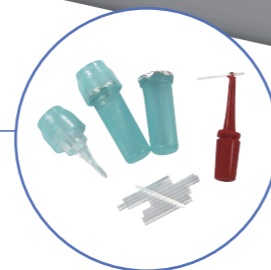

TEST PROCEDURE

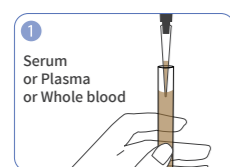

Sampling

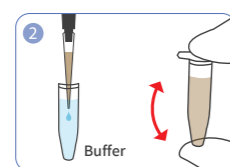

Mixing

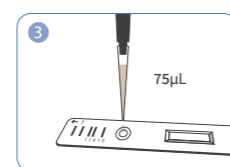

Dropping

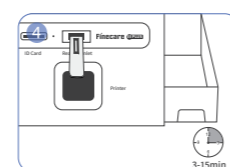

Reading

Distributed by



Meditec Instruments Co.

Deals in: Medical / Laboratory Instruments, Reagents & Consumables

HEAD OFFICE: Suite# 202, Tahir Plaza Plot No. A-20, Combi, Area Near Duty Free Shop, Karachi-75350, Pakistan
Tel# 34314280-1 Fax: (92-21) 34314282, e-mail: meditec@pacer.net.pk, Website: www.meditec.com.pk

Branches:
Karachi: 0334-2022562 / 0332-4314289
Lahore: 0334-2022564 / 042-37114799
Peshawar: 0334-2022565 / 091-22466540
Rawalpindi: 0334-2022566 / 051-3376283
Quetta: 0334-2022567 / 091-2637072
Faisalabad: 0334-2022568
Multan: 0334-2022568

APPLICATION



Laboratory



ER



ICU



Clinics



GP Office